

WATER VALVE RSWV1

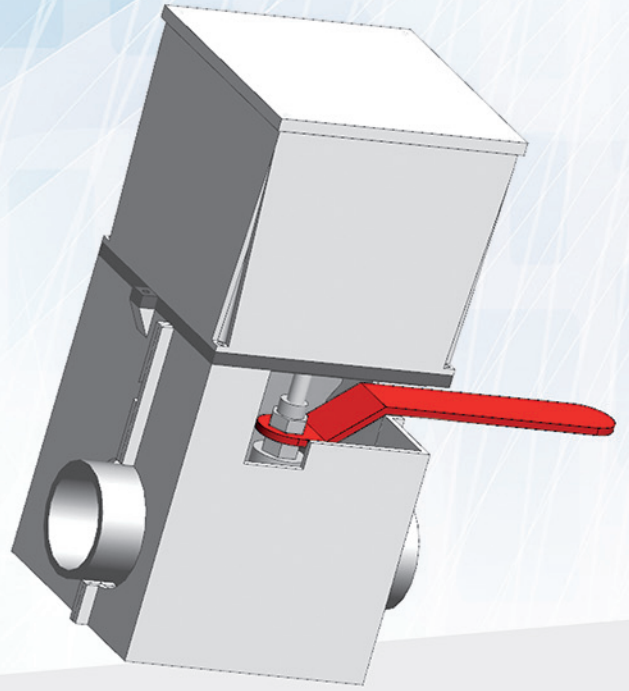

■ MAIN PURPOSE

REACOM's RSWV1 is a motorized smart water valve designed for remote control of water supply.

■ PRINCIPLE OF OPERATION

The RSWV1 water valve is equipped with a radio controlled stepper motor. It is built on the new disruptive long range LoRaWAN technology.

The Wireless controller receive the open/close command, passing it to the valve, which is executing the command and transmitting the corresponding information to the application server by checking the position of the executed state.

MAIN FEATURES

1. Open/Close valve by exact remote command
2. Open/Close heartbeat status
3. Wireless range of 10 km*
4. LoRaWANTM Class A/C compatible
5. Improved interference immunity
6. Encrypt-RF™ Security (Diffie-Hellman Key Exchange +
7. AES-128 CBC for sensor data messages)
8. DN 11/2 (or 3/4, 1, 11/4, 2)

EXAMPLE OF APPLICATIONS**

1. Landscape irrigation
2. Agriculture irrigation
3. Golf
4. Vineyard
5. Fountains

*conditions: no obstacles, direct line-of-sight.

**we recommend to use RSWV1 with RSMT3L (Soil Moisture and Temperature Sensor) and REACOM's irrigation software to ensure intelligent irrigation of your field. Integration with Third-Party irrigation system / software is also possible optional.

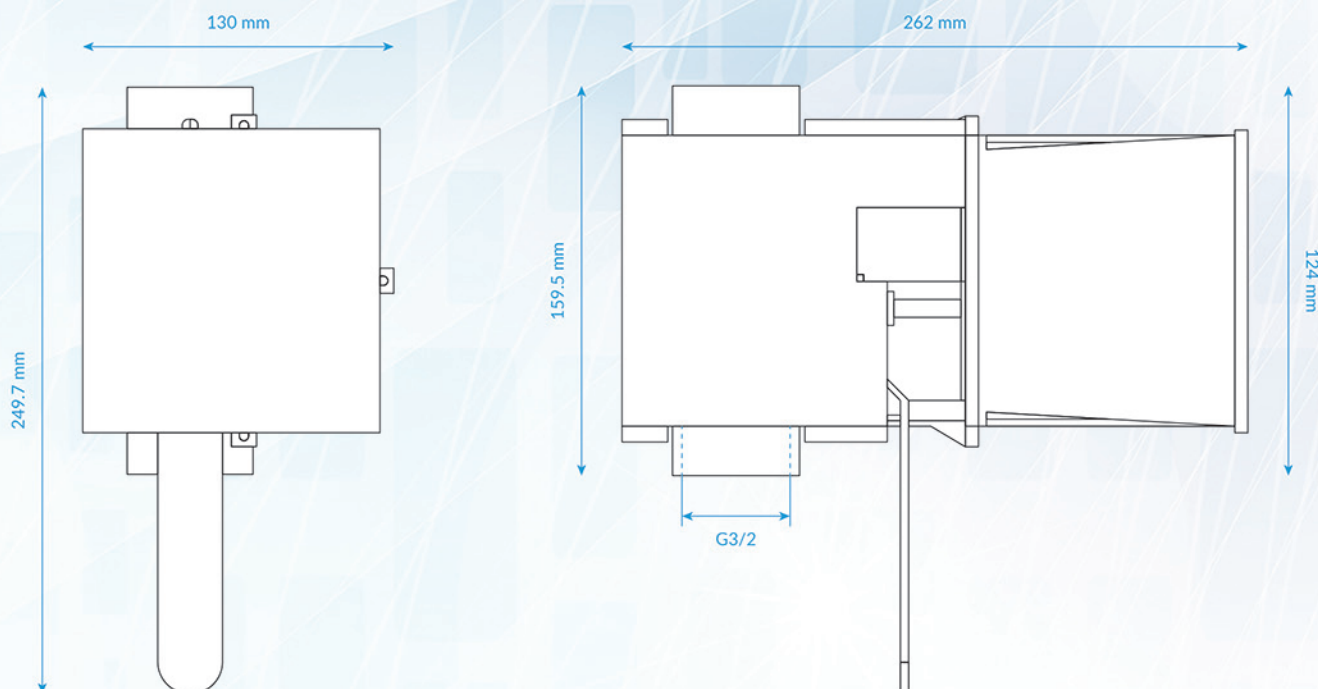

TECHNICAL SPECIFICATIONS

FREQUENCY

TX Power.....	19 dBm \pm 1d Bm	Communication Range.....	10 km (line-of-sight, the actual transmission distance depends on the environment)
Rx Sensitivity.....	-136 dBm (LoRa, Spreading Factor=7-12 Bit Rate=5470-293 bps) -121 dBm	Spread Technique.....	LoRa/FSK
Antenna Type.....	Build-in or external antenna	Available Frequency.....	EU863-870
Data Transfer Rate.....	0.3 kbps~50 kbps		Other regional bands can be configured before shipment

PHYSICAL

Main Body Dimension.....	249.7x262x130mm
Electrical power.....	~220V, 50/60 Hz, max 0.5 A
Weight.....	4 kg
Operating Temperature.....	-20° C ~ 55° C
Environment Humidity Range....	<90% RH (No condensation)
Storage Temperature.....	-40° C ~ 85° C